

# TENT OWNERS MANUAL

## **BLOCKOUT FAST FRAME 6 PERSON**

### BEFORE YOU BEGIN

- This tent requires a minimum of two people to set up
- Read all the instructions before setting up your tent. Check parts list to ensure you have full contents
- Find a Flat area for your tent, free from rocks, potholes and branches
- Ensure that you use all pegs, ropes and additional poles only as instructed
- If conditions are windy, arrange tent as to have narrowest side of tent facing into the wind
- Keep away from Open Flames, DO NOT USE Stoves or Burning Appliances inside the tent

### WARNING

#### AVOID CONTACT WITH OPEN FLAMES:

This tent is manufactured to meet CPAI-84 Fire Retardant standards. The fabric may burn if in continuous contact with open flame sources.

#### CONDENSATION IS NOT LEAKING:

Minimise condensation by ensuring your tent is well ventilated through windows, doors or vents.



### CONTENTS

- Inner Tent x 1
- Rain Fly x 1
- Front Vestibule Pole x 1
- Rear Vestibule Pole x 1
- Steel Portico Poles x 2
- Steel Awning Poles x 2
- Pegs x 26
- Guy Ropes x 8

DuraPlus Front Vestibule Pole x 1:



DuraPlus Rear Vestibule Pole x 1:



Steel Awning Pole x 2:



Steel Portico Pole x 2:



### STORAGE

- To maximise the life of your tent, always ensure it is clean of dirt and debris.
- Never store if wet or damp. Consider airing your tent at home after your trip and allow to completely dry before storing between trips
- Continued exposure to sunlight can degrade the polyesters used to make tents. Always store your tent in its storage bag, away from direct light in a cool, dry space

SPARE PARTS AND ASSISTANCE - For details see [www.oztrail.com.au](http://www.oztrail.com.au)

WARRANTY - For details see [www.oztrail.com.au/warranty](http://www.oztrail.com.au/warranty)

OZtrail® is a registered trademark of  
**Adventure Trading Australia Pty Ltd**

Designed & Imported by:  
**Adventure Trading Australia Pty Ltd**  
71 Charles Ulm Place,  
Eagle Farm, QLD 4009  
AUSTRALIA



Made in Bangladesh

# TENT OWNERS MANUAL

## BLOCKOUT FAST FRAME 6 PERSON

### STEP 1: LAYOUT THE INNER TENT

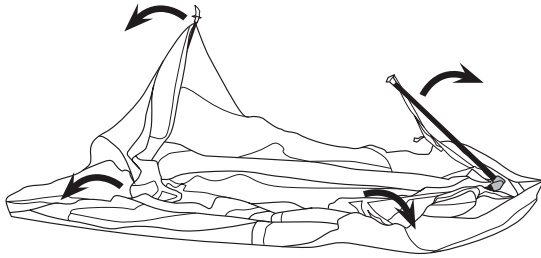

- Unfold the inner tent and outstretch over a flat, clear area
- Arrange the door so it is facing your desired area for entry & exit

### STEP 2: ERECT THE INNER TENT FRAME

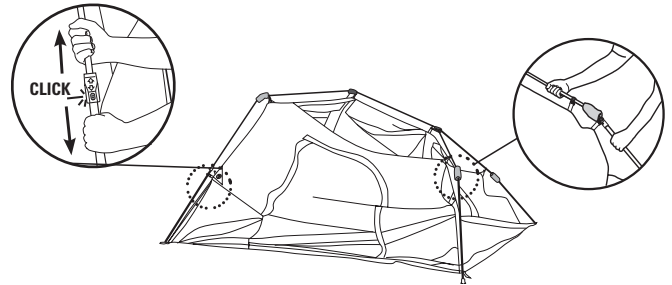

- Locate the Lower Leg section of the frame
- Raise to near vertical orientation
- Extend the leg section until the locking button clicks into the locked position
- Repeat on other legs.

### STEP 3: PUT ON THE FLY

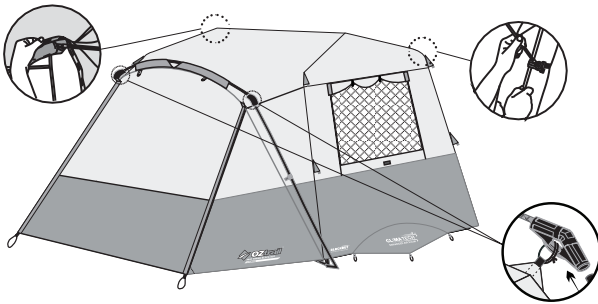

- Place rain fly over inner tent so red webbing on fly faces rear of tent
- Install rear Vestibule pole by threading through sleeve on underside of fly above rear door and inserting ends into eyelets on inner tent webbing clips
- Install Front Vestibule Pole by placing through sleeve located above the door on outside of rain fly
- Insert Vestibule pole into black plastic molding
- Insert Steel Portico Pole into opposite side of black molding
- Connect base of Portico Pole to ring and pin on Grey Webbing stitched to Inner tent corner

### STEP 4: SECURE FLY TO INNER TENT



- Secure rain fly to tent with Velcro tabs located on underside of rain fly
- Connect the fly to the tent using red and grey buckles on tent corners

### STEP 5: ASSEMBLE THE AWNINGS



- Use the awning poles and additional ropes to suspending the door panel overhead
- Peg out the tent and fly around the perimeter

### STEP 6: ALWAYS PEG OUT AND USE GUY ROPES



- In windy and rainy conditions, awnings must be dismantled, and doors must be closed, and guy ropes must be set out

### PACK UP:

TO TAKE DOWN THE TENT, REVERSE THE PREVIOUS STEPS