

TENT OWNERS MANUAL

LUMOS FAST FRAME 6 PERSON

BEFORE YOU BEGIN

- This tent requires a minimum of two people to set up
- Read all the instructions before setting up your tent. Check parts list to ensure you have full contents
- Find a Flat area for your tent, free from rocks, potholes and branches
- Ensure that you use all pegs, ropes and additional poles only as instructed
- If conditions are windy, arrange tent as to have narrowest side of tent facing into the wind
- Keep away from Open Flames, DO NOT USE Stoves or Burning Appliances inside the tent

WARNING

AVOID CONTACT WITH OPEN FLAMES:

This tent is manufactured to meet CPAI-84 Fire Retardant standards. The fabric may burn if in continuous contact with open flame sources.

CONDENSATION IS NOT LEAKING:

Minimise condensation by ensuring your tent is well ventilated through windows, doors or vents.



CONTENTS

- Inner Tent x 1
- Rain Fly x 1
- Front Vestibule Pole x 1
- Rear Vestibule Pole x 1
- Steel Portico Poles x 2
- Steel Awning Poles x 2
- Pegs x 26
- Guy Ropes x 8
- 3 D-Cell Battery Box x 1 (Batteries not Included)

DuraPlus Front Vestibule Pole x 1: 

DuraPlus Rear Vestibule Pole x 1: 

Steel Awning Pole x 2: 

Steel Portico Pole x 2: 

STORAGE

- To maximise the life of your tent, always ensure it is clean of dirt and debris.
- Never store if wet or damp. Consider airing your tent at home after your trip and allow to completely dry before storing between trips
- Continued exposure to sunlight can degrade the polyesters used to make tents. Always store your tent in its storage bag, away from direct light in a cool, dry space
- Remove D-Cell batteries from battery box prior to storing

Operating the Lumos LED Lighting System:

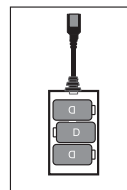

Add 3-D batteries to empty battery pack. (Batteries not included)

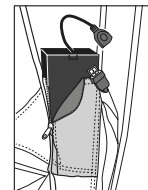

Slide battery pack into pocket located inside the tent.

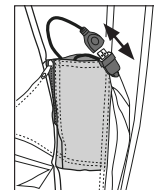

Zip up pouch, then plug in battery pack cord into lighting connector.

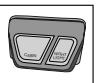

Press buttons on switch box located on either inside or outside of tent to turn on lighting.

Alternatively: Lumos System can run from a rechargeable battery pack, Not Exceeding 5V, 1A output

TENT OWNERS MANUAL

LUMOS FAST FRAME 6 PERSON

STEP 1: LAYOUT THE INNER TENT

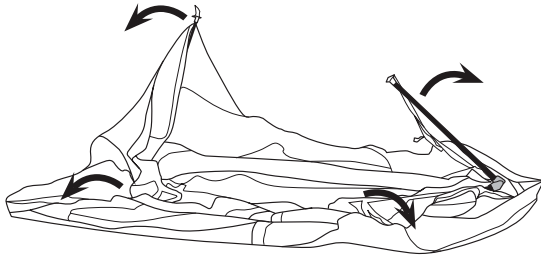

- Unfold the inner tent and outstretch over a flat, clear area
- Arrange the door so it is facing your desired area for entry & exit

STEP 2: ERECT THE INNER TENT FRAME

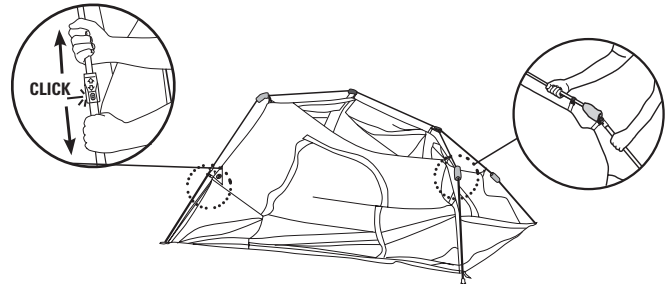

- Locate the Lower Leg section of the frame
- Raise to near vertical orientation
- Extend the leg section until the locking button clicks into the locked position
- Repeat on other legs.

STEP 3: PUT ON THE FLY

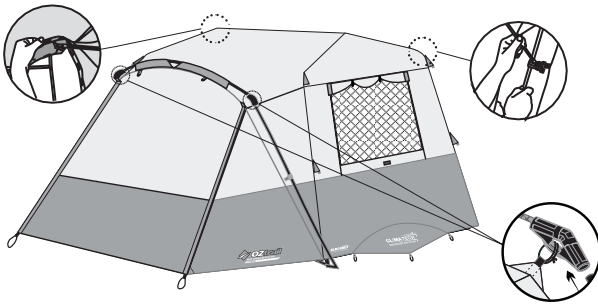

- Place rain fly over inner tent so red webbing on fly faces rear of tent
- Install rear Vestibule pole by threading through sleeve on underside of fly above rear door and inserting ends into eyelets on inner tent webbing clips
- Install Front Vestibule Pole by placing through sleeve located above the door on outside of rain fly
- Insert Vestibule pole into black plastic molding
- Insert Steel Portico Pole into opposite side of black molding
- Connect base of Portico Pole to ring and pin on Grey Webbing stitched to Inner tent corner

STEP 4: SECURE FLY TO INNER TENT



- Secure rain fly to tent with Velcro tabs located on underside of rain fly
- Connect the fly to the tent using red and grey buckles on tent corners

STEP 5: ASSEMBLE THE AWNINGS



- Use the awning poles and additional ropes to suspending the door panel overhead
- Peg out the tent and fly around the perimeter

STEP 6: ALWAYS PEG OUT AND USE GUY ROPES



- In windy and rainy conditions, awnings must be dismantled, and doors must be closed, and guy ropes must be set out

**PACK UP: REMEMBER TO REMOVE BATTERY BOX PRIOR TO PACKING
TO TAKE DOWN THE TENT, REVERSE PREVIOUS STEPS
REMEMBER TO COMPLETELY LOWER LEGS BEFORE COLLAPSING HORIZONTAL ROOF POLES**