

COMPANION

TRUSTED SINCE 1941

HIGH VOLUME CAMP SHOWER

12V DC



OWNERS MANUAL

Part No. COMP25356

IMPORTANT: Read these instructions for use carefully. Familiarise yourself with the appliance before connecting to DC power source. Keep these instructions for future reference.

UNDERSTANDING YOUR APPLIANCE

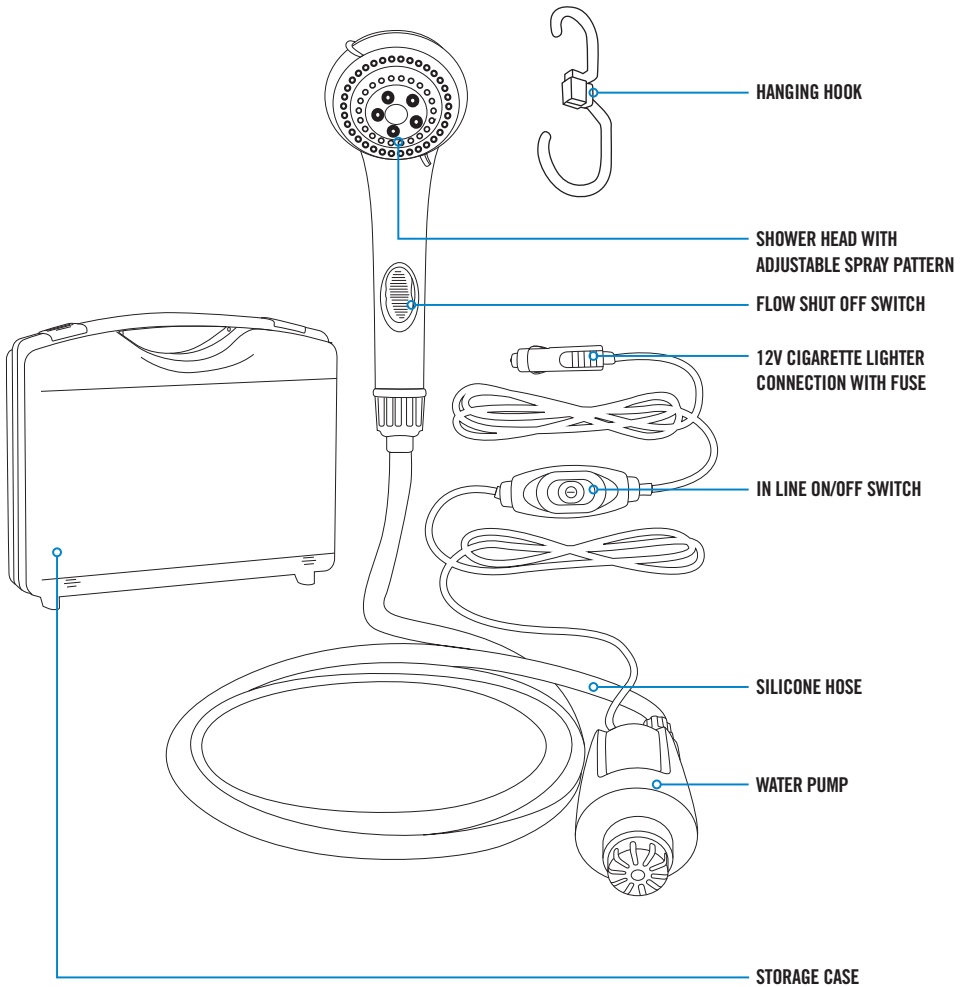

OPERATING INSTRUCTIONS

- Use clean water, do not use direct from river or lakes
- Do not operate shower without water at any time
- Ensure bucket is filled with sufficient water for intended use

Step 1. Place pump in a bucket or connect to water container. If using a bucket, ensure water pump is fully submerged in water to prevent damage.

Step 2. Insert plug into suitable 12V DC outlet and push switch on.

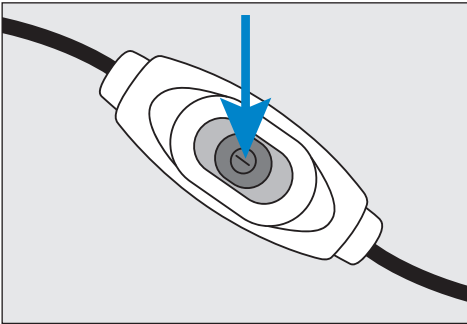

Step 3. Adjust flow of water as required using control on shower head.

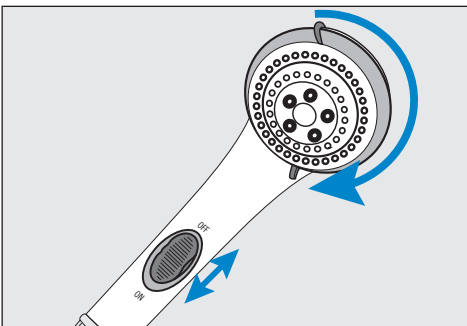

When using the camp shower, stretch the hose vertically to allow any air bubbles to escape, which may impede water flow.

IMPORTANT

Do not take the pump out of the bucket while in use and ensure it is submerged in water before use.

TROUBLE SHOOTING

IF WATER DOES NOT FLOW

- Turn off pump
- Lift pump from bucket and hold shower head vertical to draw water from shower
- Place pump in bucket and retry

IF PUMP DOES NOT RUN

- Check sufficient 12V DC power is available
- Check fuse in cigarette lighter fitting

CARE INSTRUCTION

To clean the outside of the camp shower, use only a damp cloth and mild dishwashing liquid.

SPECIFICATIONS

Part no.	COMP25356
Water flow	6 L per minute*
Power supply	12V DC
Power cord length	5 m
Silicone hose length	2 m
Fuse	5 amp
Max Draw	3 amp*

*Average

WARRANTY - For details see www.companionleisure.com.au/warranty

Companion® is a registered trademark of
Primus Australia Pty Ltd

Designed & Imported by:
Adventure Trading Australia Pty Ltd
71 Charles Ulm Place,
Eagle Farm, QLD 4009
AUSTRALIA



Made in China