

3 To Take Down Gazebo Bar Table

- Turn knobs counterclockwise to loosen hinged bracket from Gazebo Bar Table brackets. (Fig. 6)
- Rotate the hinged bracket with knob away from both leg brackets. (Fig. 6)
- Lift up on ends of Gazebo Bar Table sections and push the leg poles out of the brackets. (Fig. 7)
- Carefully lay Gazebo Bar Table on ground before folding for storage. (Fig. 8)

NOTE: Make sure to push extendable braces into fully closed position. (Fig. 8 & 9)

- Fold up Gazebo Bar Table to closed position. (Fig. 9)
- Store table in a clean and dry location.

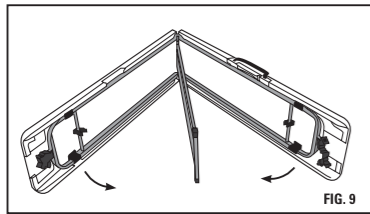
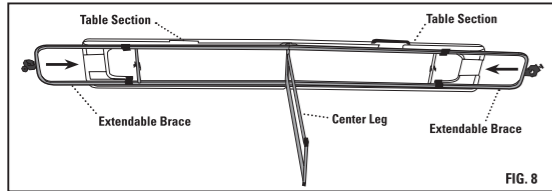
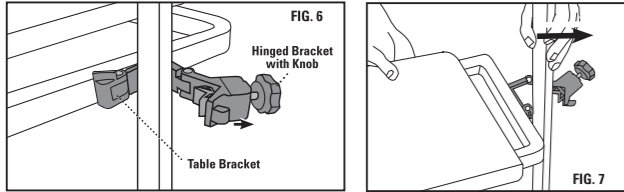

⚠ WARNING

When using this product basic safety precautions should be followed to reduce the risk of injury including the following:

- This product is shipped fully assembled. Before use verify that all of the components and fasteners are secure.
- Take care when opening and closing the product. Keep hands away from the folding mechanisms to prevent fingers being trapped and pinched.
- Do not stand on the Gazebo Bar Table.
- Always use the product on firm, level ground.
- Do not exceed 30kg on the Gazebo Bar Table.

IMPORTANT! READ CAREFULLY AND RETAIN FOR FUTURE REFERENCE

Cleaning:

- To clean the prouct, wipe with a soft, slightly moist cloth
- Never use corrosive detergents, wire brushes, abrasive scourers, metal or sharp utensils to clean the product.

Maintenance:

- Regularly check that all the components and fasteners are tightened.
- Store the product in a cool and dry place away from children and pets.
- Avoid any vibrations and shocks.

Conditions for use:

- For indoor and outdoor use.

GAZEBO BAR TABLE

NOTE: This product is designed to be used on 2.4m and 3.0m gazebos.

Assembly Instructions:

1 Set Up Gazebo Bar Table

NOTE: Locate the side of the Gazebo where you want the Gazebo Bar Table to be located then move unopened case to that location.

CAUTION: To avoid pinch points when opening or closing the Gazebo Bar Table, it is recommended that the product be set up or taken down on the ground.

- Lift and place case on end then open. (Fig. 1)
- Open fully until centre leg is perpendicular to tabletop sections. (Fig. 2).

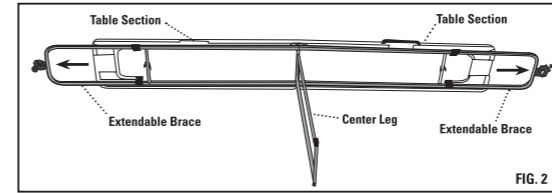
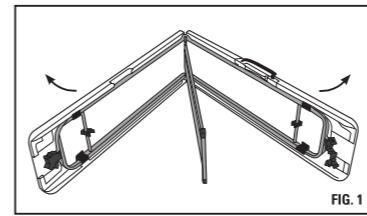

- When the Gazebo Bar Table is fully extended, lift upright and centre between legs of the gazebo opening you have selected. (Fig. 2 & 3).

NOTE: Slide extendable braces outward to fit width between legs of gazebo.

2 Secure Gazebo Bar Table to Gazebo Legs

- Lift up first Gazebo Bar Table section then place bracket onto gazebo leg pole above silver locking pin. (Fig. 3 & 4)
- Rotate hinged bracket with knob over the gazebo leg. (Fig. 3 & 4)
- Tighten knob by turning clockwise to secure end of Gazebo Bar Table to the gazebo leg. (Fig. 5)
- Attach other end of Gazebo Bar Table to other gazebo leg then tighten to secure. (Fig. 3, 4 & 5)

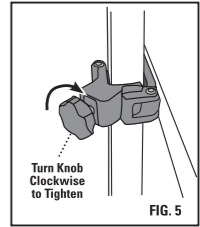
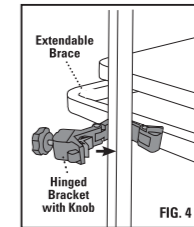
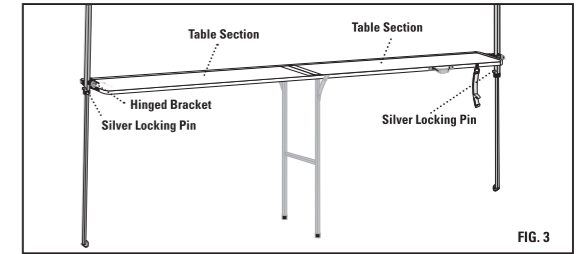

- After both knobs are tightened and the brackets are secured to the gazebo legs, your Gazebo Bar Table is ready for use.

(See other side of sheet for Gazebo Bar Table take down instructions and warnings before use.)