

ROVER™ JUMP 3600A

JUMP STARTER



INSTRUCTION MANUAL

Model No. 10001897

BEFORE USE

- The specifications and pictures in this manual are for reference only.
- When using for the first time, fully charge the unit.
- It is recommended to charge the unit every three months to prolong the life of the battery.

SAFETY INSTRUCTIONS

- Only use the included battery clamps when using the unit.
- Correctly connect the product to the positive and negative pole of the car battery that has suffered power loss or damage, this product will intelligently recognize the car battery voltage, users can instantly start the engine by switching the engine switch.
- Vehicles that have on-board computerised systems which are not designed to meet ISO 16750 standard may be damaged if vehicle battery is jump started. Before jump starting, read the vehicle owner's manual to confirm that external starting assistance is suitable. ISO 16750 is an ISO standard which provides guidance regarding environmental conditions commonly encountered by electrical and electronic systems installed in automobiles.
- Jump start procedures should only be performed in a safe, dry, well-ventilated area.
- Always store battery clamps when not in use. Never touch battery clamps together. This can cause dangerous sparks, power arcing and/or explosion.
- This unit is designed to be used only on vehicles with a 12 Volt DC battery system. Do not connect to a 6V or 24V battery system.
- This unit is not designed to be used as a replacement for a vehicular battery. Do not attempt to operate a vehicle that does not have a battery installed.
- Excessive engine cranking can damage a vehicle's starter motor. If the engine fails to start after the recommended number of attempts (no more than 5 times), discontinue jump start procedures and look for other problems that may need to be corrected.
- Keep the unit away from all metal objects to avoid short circuiting.
- Do not expose the unit to heat or direct sunlight. Keep away from high temperatures, humidity and dust.
- Do not disassemble the unit.
- Do not drop, place heavy objects or impact the unit in anyway.

- This appliance is not intended for use by persons (including children) with reduced physical, sensory or mental capabilities, or lack of experience and knowledge, unless they have been given supervision or instruction concerning use of the appliance by a person responsible for safety.
- Children should be supervised to ensure that they do not play with the unit.
- Do not cover the device with towels, clothing and other items.
- The unit may become hot when charging. This is normal, use caution when handling.
- Do not attempt to remove the battery as you may damage the unit.

UNDERSTANDING THE PRODUCT

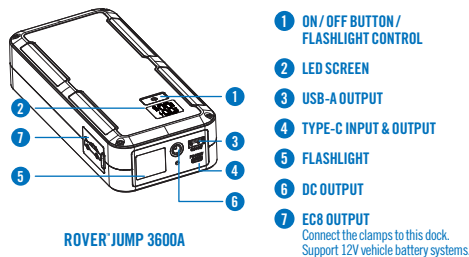

ROVER JUMP 3600A



BATTERY CLAMPS



CIG ADAPTER



USB-C CABLE



STORAGE CASE

POWER ON / OFF

ON / OFF / LED LIGHT MODES SWITCH:

Press the **POWER** button on the front of the unit to turn on. The unit will automatically turn off after 20 seconds of inactivity.

LED LIGHT MODE SWITCH:

STEP 1. Press the **POWER** button on the front of the unit to turn on. The unit will automatically turn off after 20 seconds of inactivity.

STEP 2. Single press the **POWER** button to switch between the 3 light modes - flashlight, SOS, blink.

CHARGING THE UNIT

STEP 1. Connect the unit to a power source using the **USB-C** cable.

STEP 2. Once fully charged, the display will show 100%.

STEP 3. Unplug the cable once fully charged.

NOTE: When using the unit for the first time, ensure it is fully charged. It is recommended to charge the unit every three months to prolong the life of the battery.

STARTING A VEHICLE



WARNING!

- If a vehicle cannot start due to loss of battery power or low temperature, this unit can be used to start the vehicle.
- This unit can only be used for a 12V car battery. It cannot be used on a 6V or 24V car battery. Before using this unit, ensure that the car battery voltage is 12V.
- Excessive engine cranking can damage a vehicle's starter motor. If the engine fails to start after the recommended number of attempts (no more than 5 attempts), discontinue the jump start procedures and investigate for other problems.

LOW TEMPERATURES

In below 0°C temperatures, there may not be enough power from the unit to jump start the vehicle. Try to start the vehicle, **DO NOT** exceed trying more than 5 times.

- The first jump start attempt may fail. Try to start the vehicle again without exceeding 5 attempts.
- If the vehicle cannot be started after 5 attempts, stop using the unit and investigate for other problems or contact emergency rescue for assistance.

INDICATOR LIGHTS

Green/Red Light Flashes: Standby

Green Light ON: Ready to jump start

Red Light ON / ALARM: Over voltage / Low Voltage / Reverse Polarity / Reverse Charging / Short Circuit / Over Current / Over Temperature / Over Time

CHARGING DEVICES

The unit can be used to charge small devices.

- **USB Output:** USB-A and USB-C output to charge phones, tablets, laptops, etc.
- **DC Outputs:** DC5521 outputs to charge DC devices with a DC5521 connection.

MAINTENANCE & CARE

- Store the unit away from water, heat sources and metal objects.
- To prolong the life of the battery, it is recommended to use or store the product between 10°C and 30°C.
- For long-term storage, recharge the battery every three months.
- When not in use, disconnect all cables from the unit and store in the provided storage case.

SPECIFICATIONS

Part No.	10001897
Dimensions	22.5L x 9W x 4.5H (cm)
Weight	1.12kg
Battery Type	Lithium Polymer Battery
Battery Capacity	9,000mAh 14.8V (36,000mAh 3.7V) / 133.2Wh
Lifecycle	1000 cycles
EC8 output	12V/3600A (Maximum peak power)
DC output	12~16V / 10A
USB output	5V~3A / 9V~2A / 12V~1.5A / 18W
USB-C input	5V~3A / 9V~3A / 12V~3A / 15V~3A / 20V~3.25A / PD65W
USB-C output	5V~3A / 9V~3A / 12V~3A / 15V~3A / 20V~5A / PD100W
Light modes	On, SOS, Strobe
Charge time	2.6 hours
Operating temperature	-20°C - 60°C

OPERATION

STEP 1. Before attempting to jump start the vehicle, ensure that all electronic equipment is turned off including air conditioning, lights, navigation, cameras, etc.

STEP 2. Open the unit dust cover, insert the battery clamps into the interface of EC8 output (Fig 1).

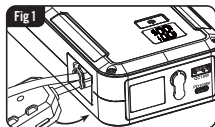

STEP 3. Clip the RED clamp on the POSITIVE electrode of the car battery, clip the BLACK clamp on the NEGATIVE electrode of the car battery (Fig 2).

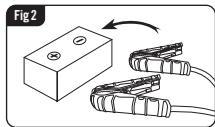

STEP 4. After correct connection, the battery clamps will activate automatically and the green/red blinking indicator light on the unit will turn to solid GREEN. Start the vehicle.

NOTE: If the green LED does not turn on, press and hold the start button on the side of the battery clamp for 3 seconds (Fig 3). After the green LED turns on, start the vehicle.

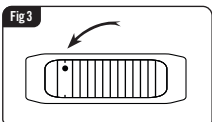

WARNING!

Do not connect the battery after pressing the start button on the battery clamp.

STEP 5. After the vehicle is successfully started, carefully remove the battery clamps from the car battery and unplug the battery clamps from the unit.

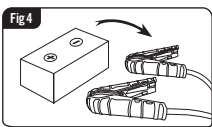

WARNING!

When removing the battery clamps from the car battery, do not connect the clamps as it may cause an electric spark and cause a short circuit protection. Separate the clamps from the unit. If a short circuit occurs, the indicator light on the unit will turn red. Disconnect the clamps from the unit.

TO THE EXTENT PERMITTED BY LAW, ADVENTURE OPERATIONS AUSTRALIA PTY LTD, ITS SUBSIDIARIES AND ITS VENDORS DISCLAIM ANY IMPLIED WARRANTIES OF MERCHANTABILITY OR FITNESS FOR A PARTICULAR PURPOSE OR ANY SIMILAR STANDARD IMPOSED BY APPLICABLE LEGISLATION AND ADVENTURE OPERATIONS AUSTRALIA PTY LTD

WARRANTY - For details see www.companionoutdoor.com/warranty
Companion[®] is a registered trademark of **Adventure Trading Australia Pty Ltd**
Designed by: **Adventure Trading Australia Pty Ltd**
71 Charles Ulm Place, Eagle Farm, QLD 4009 AUSTRALIA
Made in China

